

## Mixing valve CONTROLMIX3

Three-way mixing valve

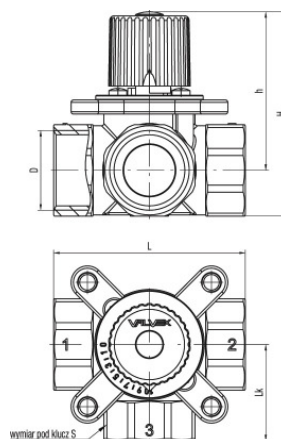

DN	Code	Dimensions							Kvs	Torque	Types of fluids	EAN13
		S	Lk	D	L	H	h					
20	6093100	31	38,5	R3/4	77	86	68	6,3 (m3/h)	<1 Nm	water, glycol (≤50%)	5902273507161	
25	6094100	39	41	R1	82	87	68	12 (m3/h)	<1 Nm	water, glycol (≤50%)	5902273507178	

### Product usage:

For use in central heating systems

### Type:

Mixing valves

### Guarantee:

25-year

### Technical data/Operating parameters:

Nom. temperature: -10°C ÷ 110°C

Nom. pressure: 1,0 Mpa

### Used materials:

body: brass, gaskets: EPDM, ABS knob and end cap, teflon lining, steel screws

### Finish:

body: brass

## Mixing valve CONTROLMIX3

Three-way mixing valve

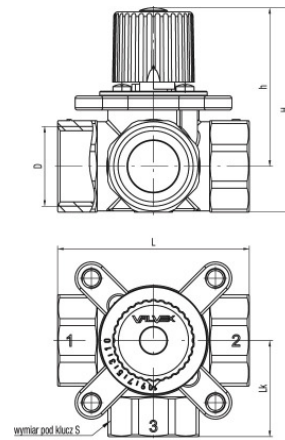
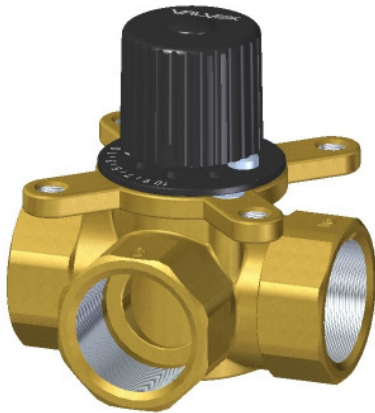

DN	Code	Dimensions							Kvs	Torque	Types of fluids	EAN13
		S	Lk	D	L	H	h					
20	6093100	31	38,5	R3/4	77	86	68	6,3 (m3/h)	<1 Nm	water, glycol (≤50%)	5902273507161	
25	6094100	39	41	R1	82	87	68	12 (m3/h)	<1 Nm	water, glycol (≤50%)	5902273507178	

### Product usage:

For use in central heating systems

### Type:

Mixing valves

### Guarantee:

25-year

### Technical data/Operating parameters:

Nom. temperature: -10°C ÷ 110°C

Nom. pressure: 1,0 Mpa

### Used materials:

body: brass, gaskets: EPDM, ABS knob and end cap, teflon lining, steel screws

### Finish:

body: brass